

TRITON

***Supri
thermostatic
shower tower***

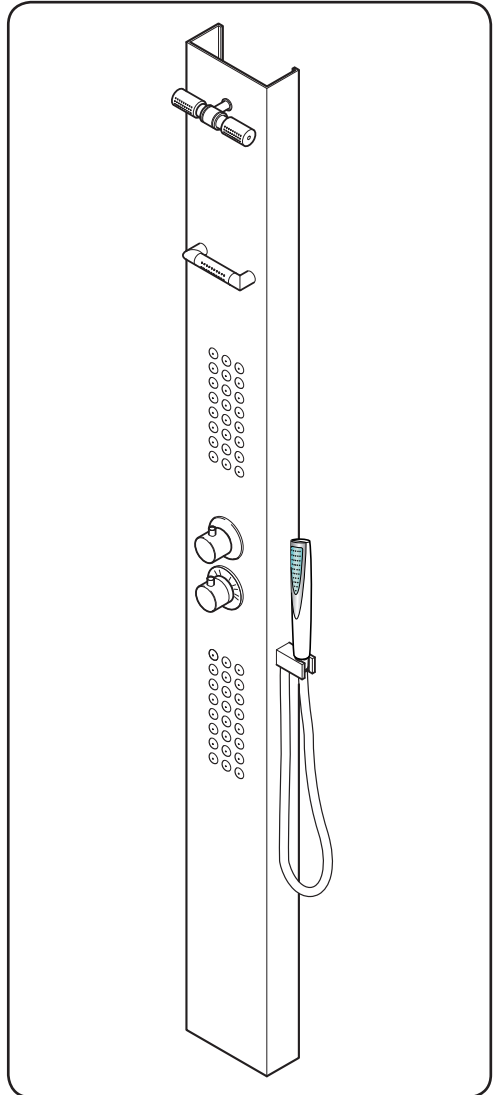

**Installation and
operating
instructions**



INSTALLERS PLEASE NOTE THESE INSTRUCTIONS ARE TO BE LEFT WITH THE USER

CONTENTS	Page
Introduction	1
Safety warnings	1
Main components	2
Site requirements	3
Typical suitable installations	4 – 5
Siting of the shower	6
Installation	6 – 10
Operating the shower	11
Cleaning	12
Spare parts	13
Fault finding	14 – 15
Guarantee, service policy, etc.	rear cover

To check the product suitability for commercial and multiple installations, please contact Triton's specification advisory service before installation.

Telephone: 0870 067 3767

Facsimile: 0870 067 3334

E mail: technical@tritonshowers.co.uk

INTRODUCTION

This book contains all the necessary fitting and operating instructions for your Triton Supri thermostatic shower tower mixer shower. Please read them carefully.

Read through the whole of this book before beginning your installation.

The shower installation must be carried out by a suitably competent person and in sequence of this instruction book.

Care taken during the installation will give a long and trouble free life from your shower.

This shower tower is designed to operate on the higher pressure systems found in the UK up to a maximum of 6 bar running pressure.

The shower MUST NOT be subjected to water temperatures above 80°C.

This mixer shower is suitable for fully modulating type combination boilers and multi-point hot water heaters. It is also suitable for thermal storage, unvented systems and pumped gravity systems.

IMPORTANT: Before installing with a gas instantaneous water heater, make sure it is capable of delivering hot water at a minimum switch-on flow rate of 3 litres per minute. At flow rates between 3 and 8 litres per minute, the appliance must be capable of raising the water temperature to a minimum of 52°C. Water temperature at the inlet to the mixer must remain relatively constant when flow rate adjustments are made (*refer to the water heater operating manual to confirm compatibility with this shower tower*).

This shower tower is supplied with an integral single check valve and integral large area filter in each inlet elbow. Inlet connections are by braided hoses having ½" BSP unions.

SAFETY WARNINGS

- a.** Layout and sizing of pipework must be such that when other services are used, pressures at the shower control inlets do not fall below the recommended minimum.
- b.** DO NOT choose a position where the shower could become frozen.
- c.** DO NOT connect this shower to any form of tap or fitting not recommended by the manufacturer.
- d.** The showerhead must be regularly cleaned to remove scale and debris.
- e.** Conveniently situated isolating valves in each inlet supply MUST be fitted as an independent method of isolating the shower should maintenance or servicing be necessary.
- f.** If it is intended to operate the shower in areas of hard water (above 200 ppm temporary hardness), a scale inhibitor may have to be fitted. For advice on the Triton scale inhibitor, please contact Customer Service.
- g.** DO NOT operate the shower outside the guidelines as laid out in 'site requirements'.
- h.** If fitting onto a tiled wall DO NOT tile around the unit. Always fit the unit on the tiles as this will ease access for servicing.

Should there be a loss of flow to either incoming supply then water from the shower will stop or be reduced to a trickle until both supplies are restored.

Replacement parts can be ordered from Triton Customer Service. See 'spare parts' for details and part numbers.

Fig.1

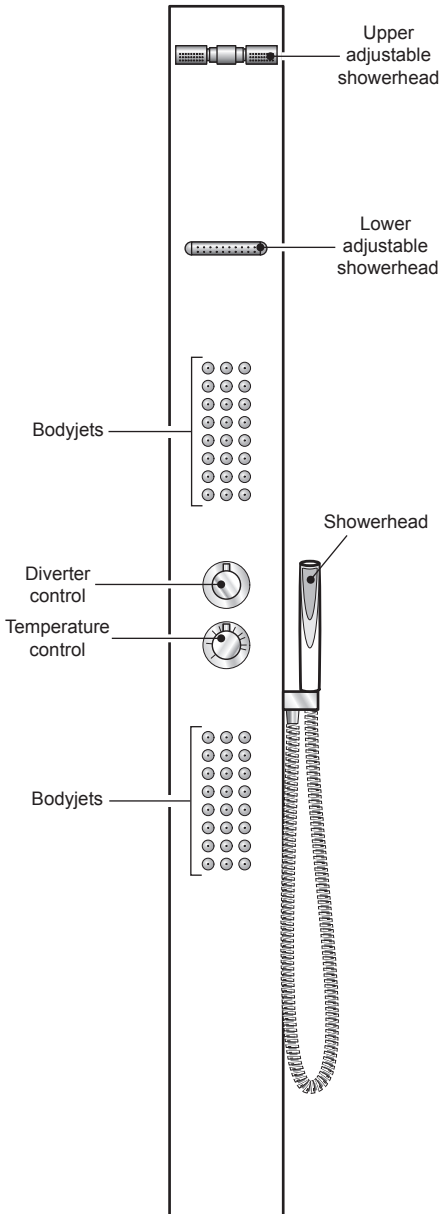

MAIN COMPONENTS

Check components and quantity before installation. In the unlikely event of anything being amiss, please contact Triton Customer Service.

Pack contents

- Shower tower body – 1 off
- Showerhead and hose – 1 off
- Hanging brackets – 2 off
- Screws and wall plugs – 4 off
- Instructions and guarantee details.

Important notes before you start

This product has passed a factory control test before reaching you. DO NOT attempt to dismantle or modify it.

- Check there are no hidden service pipes and cables where you intend to drill.
- Check the hot and cold supply pipes are flushed out before final connection to the unit.
- Please be aware of your safety while drilling and installing.

SITE REQUIREMENTS

The installation must be in accordance with Water Regulations and Bylaws.

- Minimum running water pressure: 1 bar
- Maximum running water pressure: 5 bar
- Maximum static water pressure: 10 bar

Both hot and cold supplies should be at nominally equal pressures with a minimum flow rate of 8 litres per minute to both inlets.

While the shower tower is operational (open outlet), inlet pressures must not be capable of exceeding 6 bar. For effective operation of the internal seals, the maximum static pressure must not be exceeded.

Note: On sites where the running pressure is above 6 bar, the use of a suitably sized pressure reducing valve fitted in the cold mains supply pipework can provide nominally equal pressures at the shower tower.

For a satisfactory performance from the shower tower both cold and hot inlet supplies must be from a balanced supply.

Additional isolating valves must be fitted as an independent means of isolating the water supplies should maintenance be necessary.

The pipework should be installed such that the flow is not significantly affected by other taps and appliances being operated elsewhere on the premises.

Note: Where thermal store systems and instantaneous gas water heaters are used, if excessive draw-offs take place the boiler may not be able to maintain an adequate output temperature. This could result in the shower temperature becoming noticeably cooler.

DO NOT use jointing compounds on pipework.

Water temperature requirements

Recommended maximum 65°C.

BS 6700 recommends the temperature of stored water should never exceed 65°C.

A stored water temperature of 60°C is considered sufficient to meet all normal requirements and will minimise the effects of scale in hard water areas.

Temperature adjustment range

The mixed water temperature can be adjusted from cold through to the temperature of hot water available from the hot water appliance.

Flow rate performance

For all systems, the ability to use showerheads and body jets simultaneously is dependent on domestic hot water pressures and flow rates.

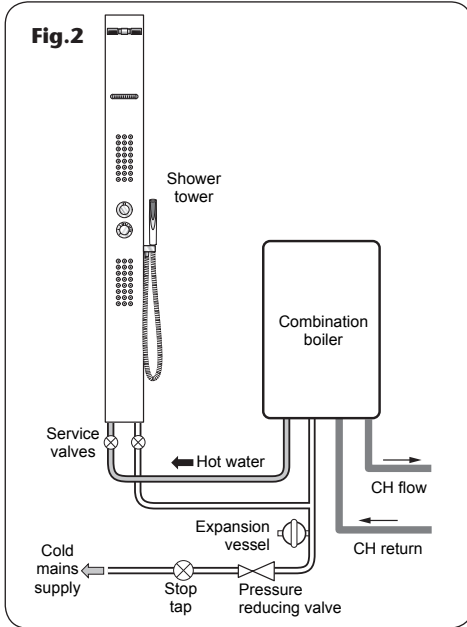

TYPICAL SUITABLE INSTALLATIONS

a) Instantaneous gas-heated systems, e.g. combination boilers (fig.2)

The shower tower can be installed with a multipoint gas water heater or combination boiler of a fully modulating design (i.e. to maintain relatively stable hot water temperatures).

A drop tight pressure reducing valve **MUST** be fitted if the supply pressures exceed 6 bar running.

An expansion vessel (typically sized at 0.16 litres) as shown in **fig.2**, **MUST** be fitted and regularly maintained, to ensure the shower mixer is not damaged by excess pressures. This may already be installed within the boiler (check with manufacturer) and is in addition to the normally larger central heating expansion vessel.

The layout and sizing of pipework **MUST** be such that nominally equal inlet supply pressures are achieved and the effects of other draw-offs are minimised.

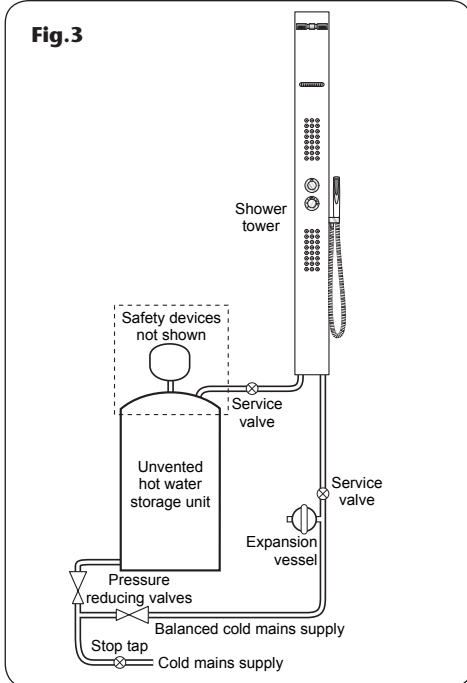

b) Unvented mains pressure systems (fig.3)

The shower tower can be installed with an unvented, stored hot water cylinder.

For systems with no cold water take off after the appliance reducing valve, it will be necessary to fit an additional drop tight pressure reducing valve when the mains pressure is over 6 bar. The drop tight pressure reducing valve **MUST** be set at the same value as the unvented package pressure reducing valve.

Note: An additional expansion vessel (0.16 litres) may be required if a second pressure reducing valve is installed. This does not apply to packages with a cold take off after the pressure reducing valve to the cylinder.

The layout and sizing of pipework **MUST** be such that nominally equal inlet supply pressures are achieved and the effects of other draw-offs are minimised.

c) High output thermal store systems (fig.4)

Packages of this type, fitted with a blender valve can be used. A drop tight pressure reducing valve MUST be fitted if the supply pressures exceed 6 bar running.

An expansion vessel (0.16 litres) as shown in **Fig.4**, MUST be fitted and regularly maintained, to ensure the unit is not damaged by excess pressures. This may already be installed externally or internally within the thermal store (check with thermal store manufacturer).

d) Pump assisted gravity fed systems (fig.5)

The pump MUST be fed from a cold water cistern and hot water cylinder providing nominally equal pressures. To use this shower tower with a gravity fed system will require the use of a pump or similar capable of providing a minimum of 1 bar to boost pressures as shown. Refer to the pump installation guide to establish the minimum head requirements for automatic operation of the pump.

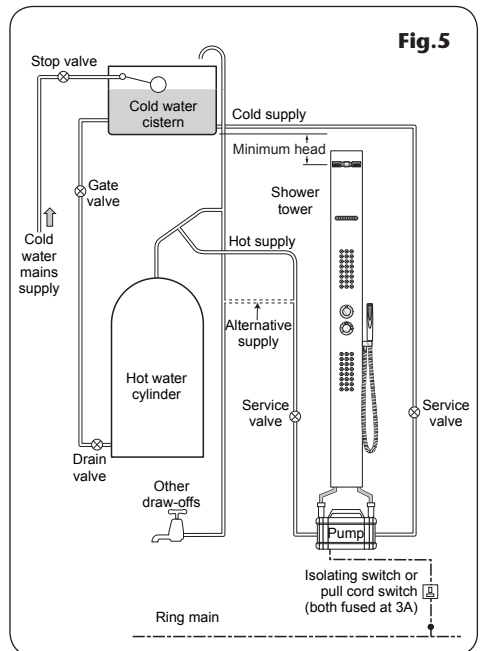
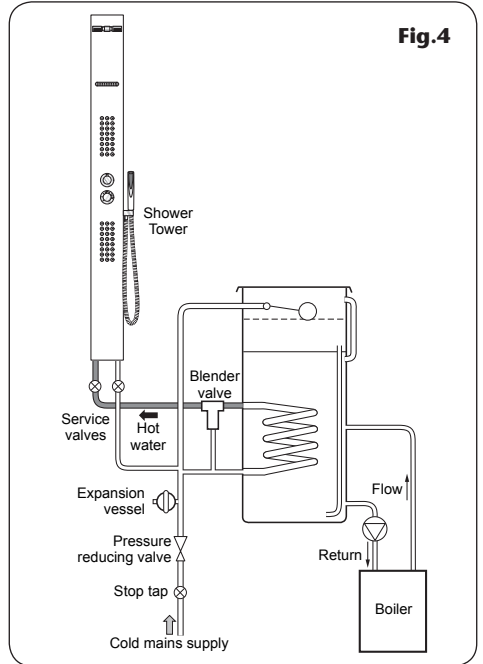

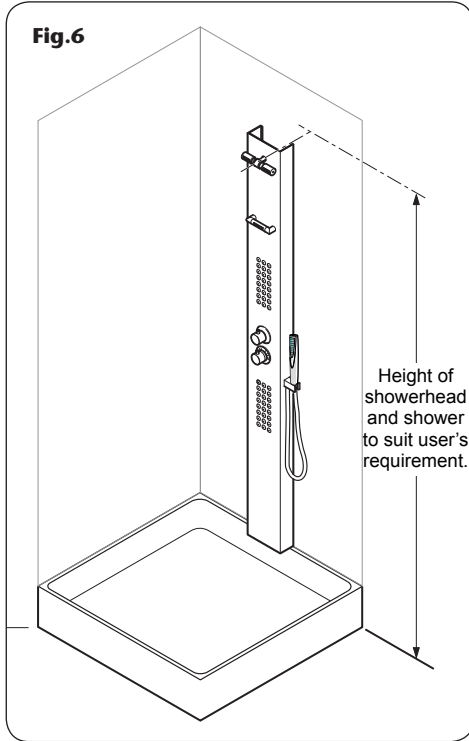

Fig.6

SITING OF THE SHOWER

Refer to (fig.6) for correct siting of the shower. The shower tower can be positioned either flush on a wall or in the corner of the cubicle.

Position the shower on the wall so that all controls can be comfortably reached while using the shower.

IMPORTANT: The hot entry piping is on the left-hand side of the mixer body.

INSTALLATION

General conditions

Note: The outlet of the shower MUST NOT be connected to anything other than the hose and showerhead supplied.

DO NOT use jointing compounds on any pipe fittings for the installation.

Use only the compression fittings supplied.

DO NOT solder fittings near the shower as heat can transfer along the pipework and may damage the seals and valves.

Note: Suitable isolating valves (complying with Water Regulations and Bylaws) MUST be fitted on the hot and cold water supplies to the shower tower as an independent means of isolating the water supplies should maintenance or servicing be necessary.

When connecting pipework avoid using tight 90° elbows. Swept or formed bends will give the best performance.

Note: Water Regulations require that where the showerhead can be lowered into the bath a double check valve or similar device MUST be fitted in the supply pipework to prevent back syphonage.

IMPORTANT: The water circuit should be installed such that the flow is not significantly affected by other taps and appliances being operated elsewhere on the premises. Water pressure must not fall below specification of the shower.

Note: Hot water pipe entry must be made to the left-hand side inlet.

Instantaneous Gas Water Heaters

In order to provide the optimum performance from the shower when connected to an instantaneous water heater, the appliance must be capable of raising the temperature of the incoming water to a minimum of 52°C and delivering a flow rate of not less than eight litres per minute.

Fitting the pipework

Establish the required position of the shower tower, and mark two holes for the incoming water supplies.

For a wall mounted shower tower the suggested final separation between pipe centres is 120 mm (**fig.7**).

Remove the plaster and brickwork (or plasterboard) to the depth required and chase out the additional areas to allow for the incoming pipework.

Complete the outlet pipework with standard 15 mm x ½" BSP male connectors (**fig.8**).

Note: Flush the pipework (**fig.9**) to clear the system of debris and check for leaks.

Complete any plastering and tiling.

IMPORTANT: Using a suitable sealant, always seal around the incoming pipework to prevent water entering the wall.

Note: Pipes can be surface mounted.

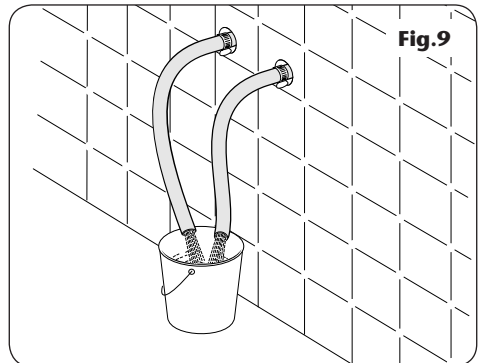
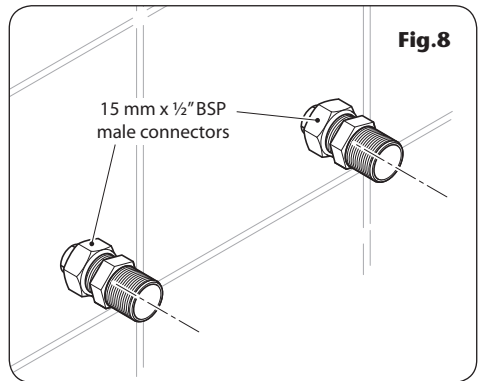
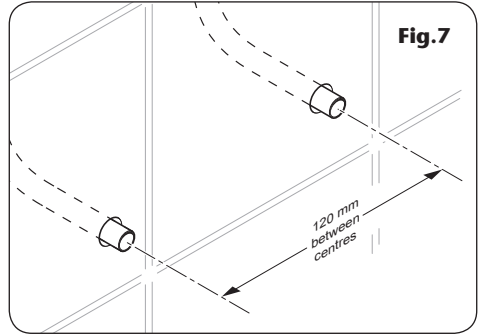

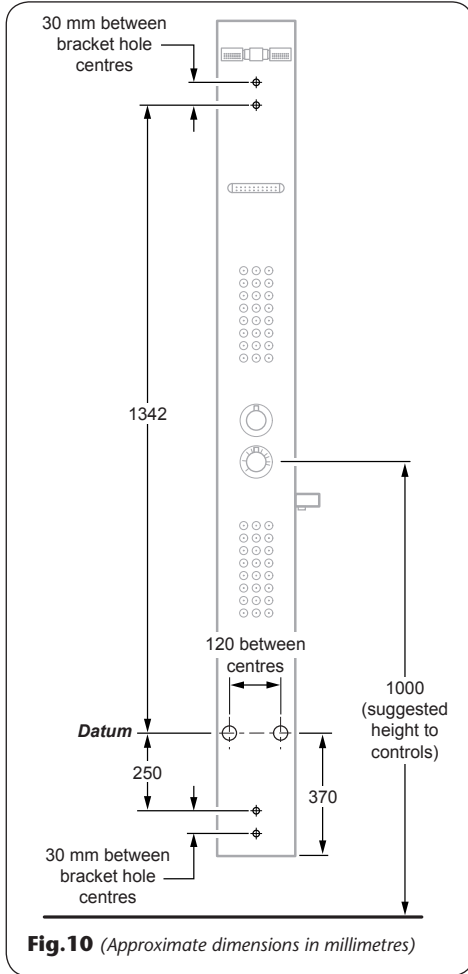

Fitting the hanging brackets

IMPORTANT: If fitting to a tiled wall, always mount the shower tower on the surface of the tiles. NEVER tile up to the shower tower.

Using the centres of the supply holes as the datum line, mark the position for the four locating screws for the hanging brackets (**fig.10**). Make sure the brackets align vertically and horizontally.

Drill and plug the wall using the wall plugs provided (*the wall plugs are suitable for most brick walls — use an appropriate masonry drill, but if the wall is plasterboard or a soft building block, use suitable wall plugs and an appropriate drill bit*).

Secure the hanging brackets to the wall using the screws supplied (**fig.11**).

Note: The bracket mounting holes are elongated to allow for a small degree of adjustment.

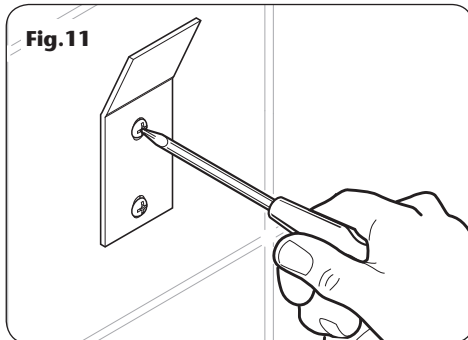

Fitting the showerhead holder

Insert the showerhead holder into the opening in the side of the shower tower and hold in position with the silicon washer and lock nut (**fig.12**). Make sure the threaded outlet on the showerhead holder faces down before tightening the lock nut. Making sure the sealing washer is in place in the connector, attach the flexible hose to the threaded outlet (**fig.12**).

Fitting the shower tower body

Insert the filters into the flexible hose inlets (**fig.13**).

Facing the front of the shower tower body, connect the right-hand flexible hose, as indicated by the blue ring on the connector, to the cold water outlet. Connect the left-hand flexible hose, as indicated by the red ring on the connector, to the hot water outlet (**fig.14**).

Screw tightly to avoid leaking.

With the pipework now connected, hitch the two support bars inside the shower body onto the hanging brackets on the wall.

Make sure the installation is stable.

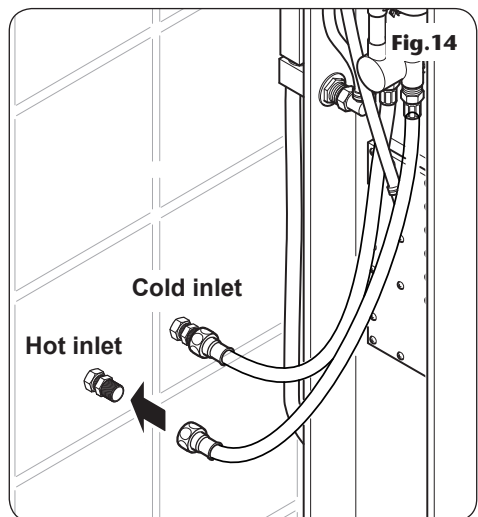
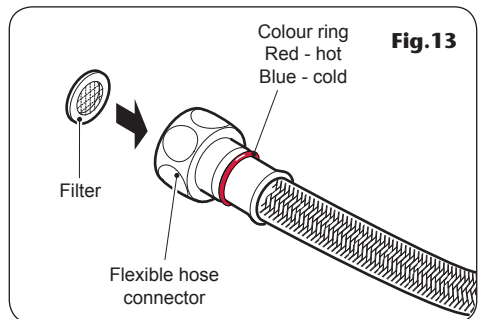
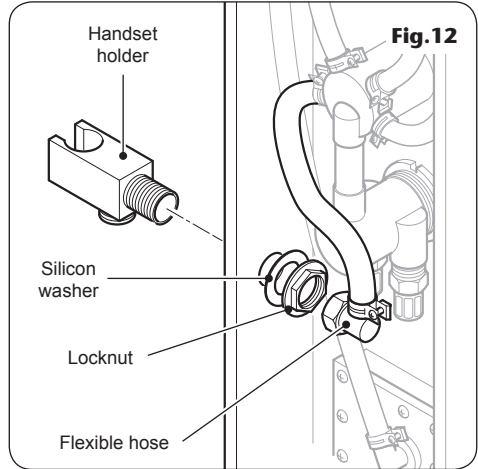

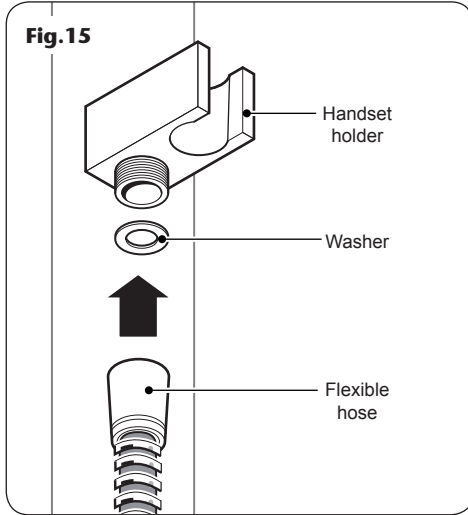

Fitting the showerhead and hose

With the sealing washers in place, connect the one end of the flexible hose to the outlet in the bottom of the showerhead holder (**fig.15**) and the other end of the hose to the showerhead.

Locate the showerhead into the holder.

Check the pipework is stable and watertight to avoid leaks before using the shower tower.

Note: DO NOT use silicon sealant around the shower tower since it may be necessary to access and clean the inlet filters periodically.

OPERATING THE SHOWER

The controls are shown in **fig.16**.

Using the diverter valve control

The diverter valve controls which of the water outlets operates.



Rotate the diverter control to this position and water will flow from the upper showerhead.



Rotate the diverter control to this position and water will flow from the lower showerhead.



Rotate the diverter control to this position and water will flow from both the upper and lower bodyjets.



Rotate the diverter control to this position and water will flow from the handset showerhead.

OFF

Rotate the diverter control to this position and water will cease to flow.

Using the temperature control

To obtain hot water rotate the temperature control anti-clockwise.

To obtain cooler water rotate the temperature control clockwise.

The shower tower is fitted with a maximum temperature override button factory set at 38°C. To override the maximum temperature press the override button on the control as you turn it anti-clockwise. To return to a cooler temperature simply rotate the control clockwise.

This should be checked to make sure the setting has not been altered and to ensure user safety.

CAUTION: It is recommended that persons who may have difficulty understanding or operating the controls should not be left unattended while using the shower tower. Special consideration should be given to young children and the less able bodied.

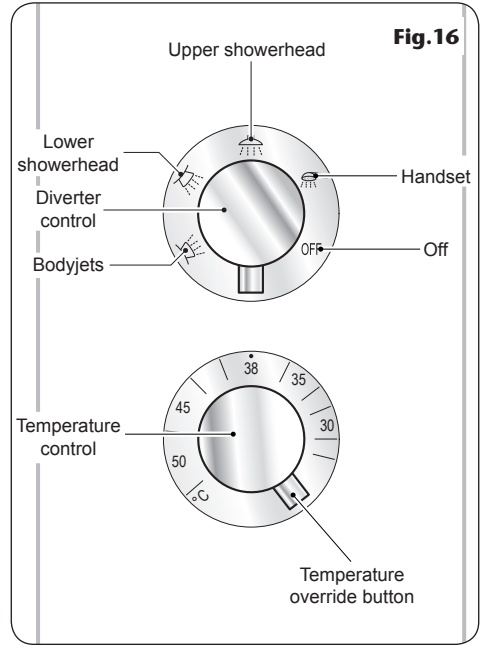

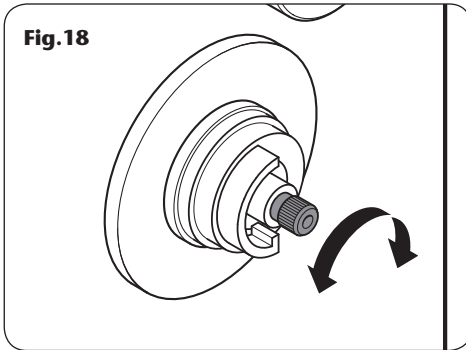
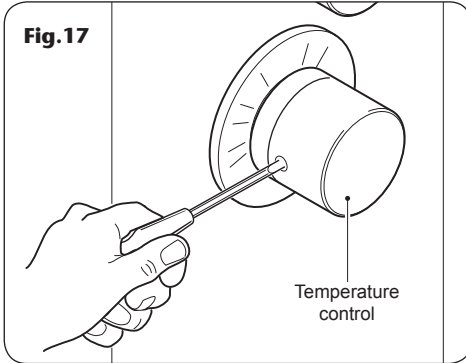

Adjusting the maximum temperature override setting

To remove the temperature control unscrew the grub screw in its base (**fig.17**). Pull the control off to exposed the temperature spindle.

Rotate the diverter control to the handset showerhead position and allow the shower tower to run. With a steady flow running, adjust the temperature valve spindle (**fig.18**) until the temperature is about 38°C (turn clockwise for cold and anti-clockwise for warm).

When you are satisfied with the temperature turn the diverter control to off. Refit the temperature control to the 12 o'clock position, checking that the temperature stop aligns with the '38°C' the shower tower body. Secure with the screw.

CLEANING

Clean the unit frequently and regularly with clean water or mild liquid detergent then rinse with clean water, and dry it with soft cotton cloth.

DO NOT use acid or abrasive detergents.

Should spare parts be required in the future, contact Customer Service.

SPARE PARTS

Ref	Description	Spares No.
1.	Upper showerhead	83311120
2.	Lower showerhead	83311130
3.	Showerhead holder	83311140
4.	Control knob assembly	83311150
5.	Diverter cartridge	83311160
6.	Temperature cartridge	83311170
7.	Emma showerhead	88500005
8.	Flexible hoses available in the following sizes:	
	1.00 m in white, chrome and gold	
	1.25 m in white, chrome and gold	
	1.75 m in chrome only	

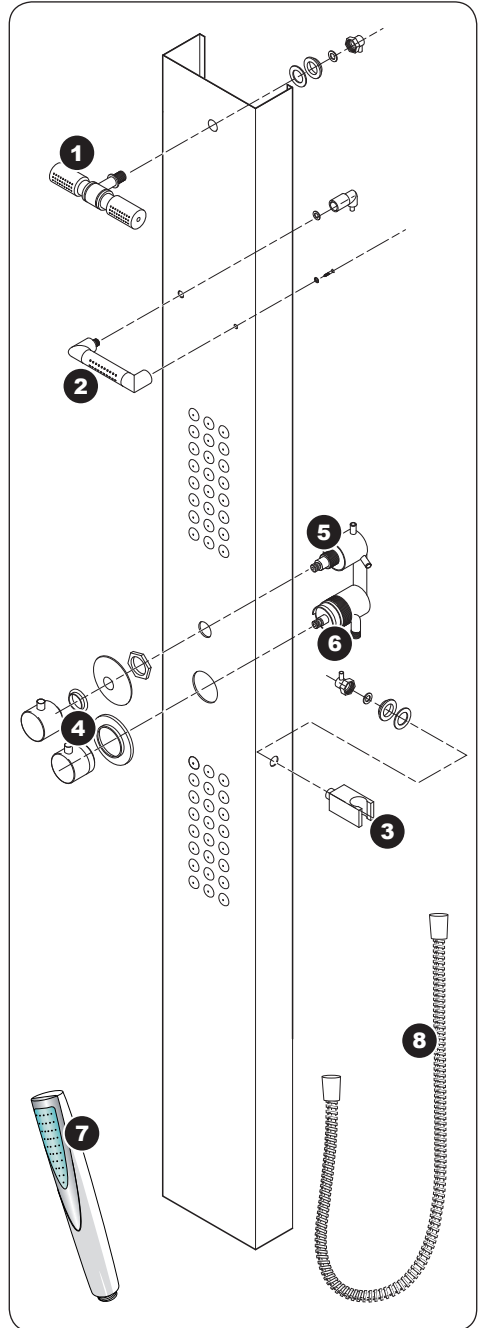

FAULT FINDING

The following can be carried out by a competent person

Problem/Symptom	Cause	Action/Cure
1 Water too hot.	1.1 Not enough cold water flowing through shower.	1.1.1 Turn temperature control clockwise.
	1.2 Increase in the ambient cold water temperature.	1.2.1 Turn temperature control clockwise.
	1.3 Cold water supply blocked.	1.3.1 Check filters are clean. 1.3.2 Turn off shower and consult a competent plumber or contact Triton Customer Service.
	1.4 High volume of cold water drawn off elsewhere.	1.4.1 Reduce the simultaneous demand from the supply.
2 Water too cold.	2.1 Not enough hot water flowing through shower.	2.1.1 Turn the temperature control anti-clockwise.
	2.2 Decrease in the ambient cold water temperature.	2.2.1 Turn the temperature control anti-clockwise.
	2.3 Insufficient hot water supplies from the heating system.	2.3.1 Make sure heating appliance is set to maximum or has sufficient stored hot water. 2.3.2 Ensure heating appliance is igniting by trying a hot water tap elsewhere.
	2.4 Hot water supply blocked or restricted.	2.4.1 Check the filters are clean. 2.4.2 Turn off shower and consult a competent plumber or contact Triton Customer Service.
3 Water does not flow or shower pattern collapses when another outlet is turned on.	3.1 Water supplies cut off.	3.1.1 Check water elsewhere in house and if necessary contact local water company.
	3.2 Shower unit blocked.	3.2.1 Inspect the inlet filters. Clean if necessary.
	3.3 Blockage in pipework.	3.3.1 Turn the shower off and consult a suitably competent plumber.
	3.4 Showerhead blocked.	3.4.1 Clean showerhead.
	3.5 System not capable of supplying multiple outlets at the same time.	3.5.1 Reduce the simultaneous demand. 3.5.2 Ensure stop/service valves are fully open. 3.5.3 Check if sufficient water pressure.

FAULT FINDING

The following is recommended for a professional qualified installer only

Problem/Symptom	Cause	Action/Cure
4 Water too cold.	4.1 Running pressure in excess of maximum recommended.	4.1.1 Fit a pressure reducing valve.
5 Shower controls noisy while in use.	5.1 Running pressure in excess of maximum recommended.	5.1.1 Fit a pressure reducing valve.
6 Shower will not shut off.	6.1 Pipework not flushed before connecting the unit (diverter valve damaged).	6.1.1 Renew diverter valve.



Service Policy

In the event of a complaint occurring, the following procedure should be followed:

- 1 Telephone Customer Service on 0870 067 3333 (0845 762 6591 in Scotland and in Northern Ireland), having available the model number and power rating of the product, together with the date of purchase.
- 2 Triton Customer Service will be able to confirm whether the fault can be rectified by either the provision of a replacement part or a site visit from a qualified Triton service engineer.
- 3 If a service call is required the unit must be fully installed for the call to be booked and the date confirmed. In order to speed up your request, please have your postcode available when booking a service call.
- 4 It is essential that you or an appointed representative (who must be a person of 18 years of age or more) is present during the service engineer's visit and receipt of purchase is shown.
- 5 A charge will be made in the event of an aborted service call by you but not by us, or where a call under the terms of guarantee has been booked and the failure is not product related (i.e. scaling and furring, incorrect water pressure).
- 6 If the product is no longer covered by the guarantee, a charge will be made for the site visit and for any parts supplied.
- 7 Service charges are based on the account being settled when work is complete, the engineer will then request payment for the invoice. If this is not made to the service engineer or settled within ten working days, an administration charge will be added.

Replacement Parts Policy

Availability: It is the policy of Triton to maintain availability of parts for the current range of products for supply after the guarantee has expired. Stocks of spare parts will be maintained for the duration of the product's manufacture and for a period of five years thereafter.

In the event of a spare part not being available a substitute part will be supplied.

Payment: The following payment methods can be used to obtain spare parts:

- 1 By post, pre-payment of pro forma invoice by cheque or money order.
- 2 By telephone, quoting credit card (MasterCard or Visa) details.
- 3 By website order, www.tritonshowers.co.uk

Triton Showers
Triton Road
Nuneaton
Warwickshire CV11 4NR

Triton is a division of Norcross Group (Holdings) Limited

TRITON STANDARD GUARANTEE

Triton guarantee this product against all mechanical defects arising from faulty workmanship or materials for a period of one year for domestic use only, from the date of purchase, provided that it has been installed by a competent person in full accordance with the fitting instructions.

Any part found to be defective during this guarantee period we undertake to repair or replace at our option without charge so long as it has been properly maintained and operated in accordance with the operating instructions, and has not been subject to misuse or damage.

This product must not be taken apart, modified or repaired except by a person authorised by Triton. This guarantee applies only to products installed within the United Kingdom and does not apply to products used commercially. This guarantee does not affect your statutory rights.

What is not covered:

- 1 Breakdown due to: *a*) use other than domestic use by you or your resident family; *b*) wilful act or neglect; *c*) any malfunction resulting from the incorrect use or quality of water or incorrect setting of controls; *d*) faulty installation.
- 2 Repair costs for damage caused by foreign objects or substances.
- 3 Total loss of the product due to non-availability of parts.
- 4 Compensation for loss of use of the product or consequential loss of any kind.
- 5 Call out charges where no fault has been found with the appliance.
- 6 The cost of repair or replacement of showerheads, hoses, riser rails and/or wall brackets or any other accessories installed at the same time.
- 7 The cost of routine maintenance, adjustments, overhaul modifications or loss or damage arising therefrom, including the cost of repairing damage, breakdown, malfunction caused by corrosion, furring, pipe scaling, limescale, system debris or frost.

Customer Service: ☎ 0870 067 3333

Scottish and Northern Ireland

Customer Service: ☎ 0845 762 6591

Trade Installer Hotline: ☎ 0870 067 3767

Fax: 0870 067 3334

www.tritonshowers.co.uk

E mail: technical@tritonshowers.co.uk